



## Emergency Evacuation Plan

It is important to be prepared in case of an emergency. Please take time to review this plan and have your individual plan ready.

- Customer will be assigned a section (A or B)
- Customers will be required to provide Evans RV Park with at least one phone number, preferably two, as an emergency contact.
- In the case of a need to evacuate, customers affected will be notified by phone number they provided to Evans RV Park
- If notified, the customer must disconnect from the site water, power, and sewer
- Customer will need to hitch their camper/tiny home and proceed to the gate assigned to their section
  - Section A will exit via the West Gate
  - Section B will exit via the East Gate
  - Turn left, heading west and proceed towards highway 85

Evans RV Park management will take the following steps in case of an emergency:

- Monitor the emergency contact system
- Notify customers by phone (provided by customer) if they are affected by a need to evacuate.
- Open all gates (West and East)
- Monitor evacuation proceedings to help maintain control and order

# Emergency Exit Map

Evans RV Park ▪ 200 37th St, Evans, CO 80620  
Office (970) 616-5501 ▪ Emergency (970) 616-5502

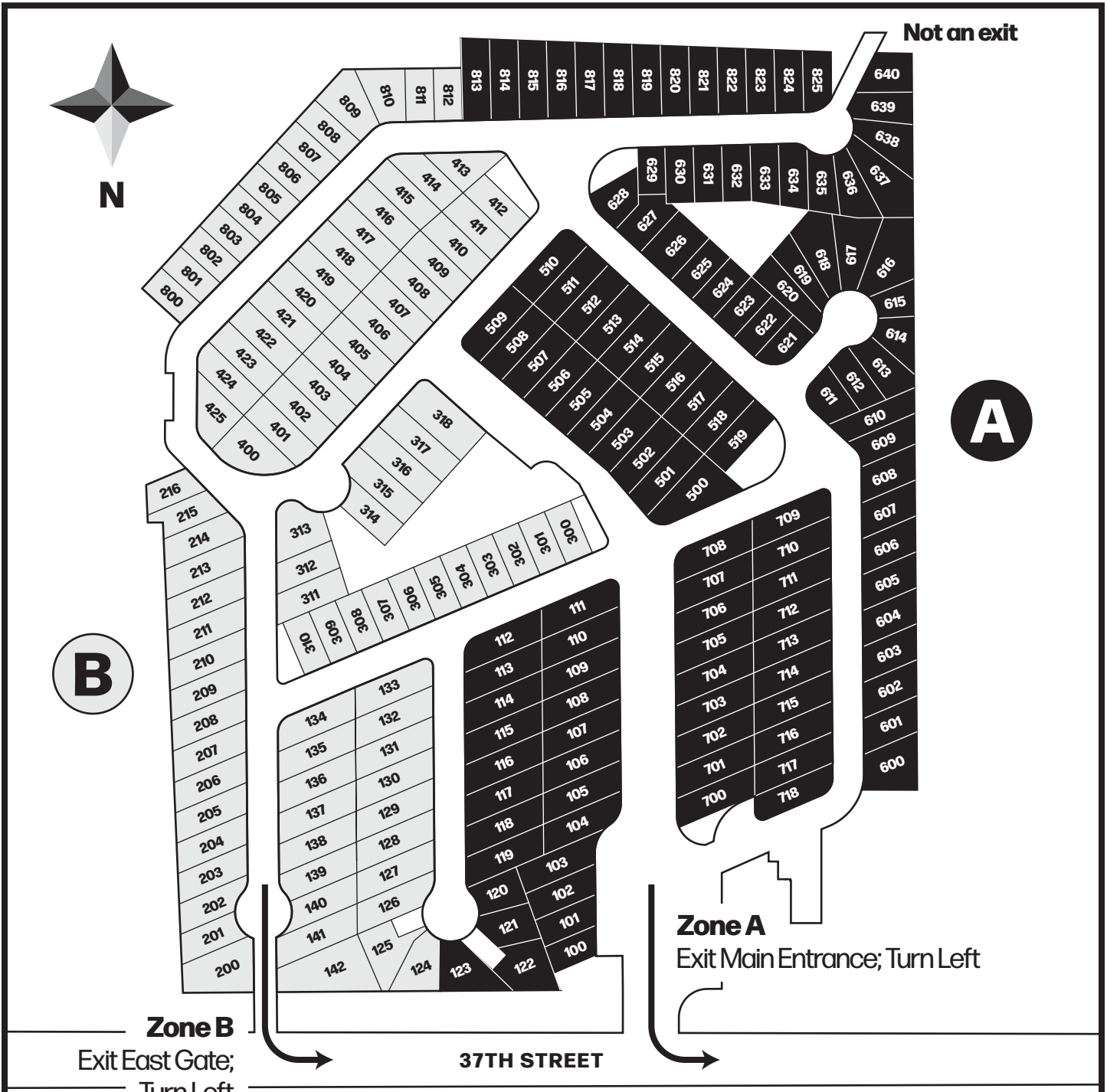

**Zone B**  
Exit East Gate;  
Turn Left

**Zone A**  
Exit Main Entrance; Turn Left

Site	Zone	Site	Zone	Site	Zone
100-123	A	300-318	B	700-718	A
124-142	B	400-418	B	800-812	B
200-216	B	500-519	A	813-825	A
		600-640	B		

# Regional Map

Please turn LEFT (west) out of the park in case of emergency,  
and proceed to US Highway 85.

